

The Satilla | Villa Apartment

1,386 S/F | Two Bedroom | Two Bath

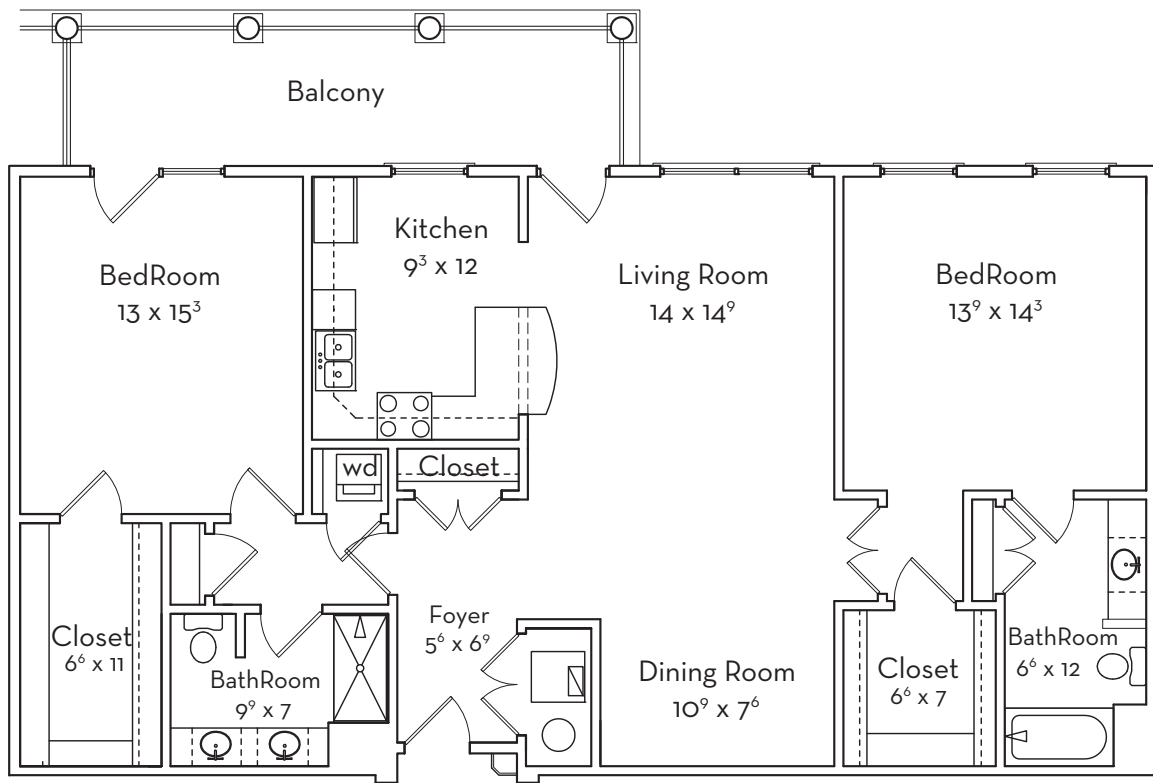

- Maintenance-Free Living
- Weekly Housekeeping
- Daily Dining
- Bill Payment
- Transportation
- Safety
- Pets Welcome
- 24-hour emergency call system
- Bring Your Own Furniture
- Transition Services
- Award-Winning Wellness Center
- Access to Health Care
- Heated Indoor Pool
- Signature Events & Social Gatherings

SENIORLIVING
COMMUNITIES

4 of 7
Villa Apartment Floorplans

136 Marsh's Edge Lane
St. Simons Island, GA 31522
Phone: 912-291-2000
www.Marshs-Edge.com